

# **INITIAL RECEIPT**

**United States Department of the Interior  
Bureau of Land Management  
DIV OF LANDS, MINRLS & ENERGY  
ONE N CENTRAL AVE  
PHOENIX, AZ 85004 -4427  
Phone: 602-417-9200**

|         |         |
|---------|---------|
| Receipt |         |
| No:     | 4850021 |

|   |
|---|
| <b>Transaction #:</b> 4978376   |
| <b>Date of Transaction:</b> 12/10/2020                                    |
| <b>CUSTOMER:</b>  |
| NIGHT HAWK MINING<br>3939 BARBARA LOOP SE<br>RIO RANCHO, NM 87124-1054 US |

| LINE #        | QTY  | DESCRIPTION   | REMARKS | UNIT PRICE | TOTAL           |
|---------------|------|---|---------|------------|-----------------|
| 1             | 1.00 | LOCATABLE MINERALS / MINING CLAIMS-NEW, UNADJUD, ONE OR MORE AUTH NOS / NEW MINING CLAIM PROCESSING FEE<br><b>CASES: AMC462234/\$20.00</b>    |         | - n/a -    | 20.00           |
| 2             | 1.00 | LOCATABLE MINERALS / MINING CLAIMS-NEW, UNADJUD, ONE OR MORE AUTH NOS / NEW MINING CLAIMS LOCATION FEE<br><b>CASES: AMC462234/\$40.00</b>     |         | - n/a -    | 40.00           |
| 3             | 1.00 | LOCATABLE MINERALS / MINING CLAIMS-NEW, UNADJUD, ONE OR MORE AUTH NOS / NEW MINING CLAIMS MAINTENANCE FEE<br><b>CASES: AMC462234/\$165.00</b> |         | - n/a -    | 165.00          |
| <b>TOTAL:</b> |      |   |         |            | <b>\$225.00</b> |

| PAYMENT INFORMATION |           |  |                      |
|---------------------|-----------|--|----------------------|
| 1                   | AMOUNT:   | 225.00   | POSTMARKED: N/A      |
|                     | TYPE:     | CHECK  | RECEIVED: 12/08/2020 |
|                     | CHECK NO: | 1318   |                      |
|                     | NAME:     | NIGHT HAWK MINING<br>112 N CURRY ST<br>CARSON CITY NV 89703 US |                      |

**ENTERED**  
DEC 21 2020  
BY: ZWU

|         |
|---------|
| REMARKS |
|         |

This receipt was generated by the automated BLM Collections and Billing System and is a paper representation of a portion of the official electronic record contained therein.

# **CORRESPONDENCE**

# **TRANSFERS**

**MAINTENANCE FEES**  
**WAIVERS**  
**POL/NOI**

# **MISCELLANEOUS**

**LOCATION NOTICES  
AMENDMENTS  
STATUS SHEET  
GEO REPORT/MTP**

# MINING CLAIM STATUS REPORT - Assessment Year 2020

Data Entered: 12/21/2020 WV

MTP Checked By: WV  
GEO Checked By: WV

LEAD SERIAL NUMBER: AMC 462234 thru AMC \_\_\_\_\_

|                                |                    |                                    |               |
|--------------------------------|--------------------|------------------------------------|---------------|
| NUMBER OF CLAIMS & TYPE:       |                    | CHARGES:                           |               |
| _____                          | LODE               | Processing Fee @ \$20 =            | \$ <u>20</u>  |
| <u>1</u>                       | PLACER             | Location Fee @ \$40 =              | \$ <u>40</u>  |
| _____                          | ASSOCIATION PLACER | Maintenance Fee @ \$165 =          | \$ <u>165</u> |
| _____                          | MILL SITE          | Add'l Maint Fee for Assoc Placer = | \$ _____      |
| _____                          | TUNNEL SITE        | <b>SUBTOTAL</b>                    | \$ _____      |
| TOTAL ACREAGE: _____ Per Claim |                    | Other Fees                         | \$ _____      |
| (Placer Only)                  |                    | Other Fees                         | \$ _____      |
| NUMBER OF LOCATORS: _____      |                    | <b>TOTAL</b>                       | \$ <u>225</u> |

DOCUMENTS RECEIVED VIA: Over-the-Counter [ ] Mail  **TIMELY FILED:** Yes  No [ ]

LEGAL DESCRIPTION: T 12N R 3W SEC 15  
T \_\_\_\_\_ R \_\_\_\_\_ SEC \_\_\_\_\_  
T \_\_\_\_\_ R \_\_\_\_\_ SEC \_\_\_\_\_  
T \_\_\_\_\_ R \_\_\_\_\_ SEC \_\_\_\_\_  
T \_\_\_\_\_ R \_\_\_\_\_ SEC \_\_\_\_\_

BLM [ ] FOREST SERVICE [ ] \_\_\_\_\_ SUBJ TO PL 359: Yes [ ] No [ ]  
WILDERNESS AREA [ ] \_\_\_\_\_

SPLIT ESTATE: N/A [ ] SX [ ] PX [ ] OTHER [ ] \_\_\_\_\_  
SRHA [ ] Was proper Notice filed if located on SHRA Land? Yes [ ] No [ ]

RECONVEYED MINERALS ON BLM LAND REQUIRE OPENING ORDER FROM 1944 TO 1993:  
Open to Entry On \_\_\_\_\_ N/A [ ]

COMMENTS/STATUS: VOID [ ] PARTIALLY VOID [ ] PVT MINERALS [ ] WITHDRAWN LANDS [ ]  
OTHER [ ] \_\_\_\_\_

[ ] Claimant acknowledges that portions of the following claim(s) site(s) may be void or voidable.

Printed Name of Claimant 1 Signature of Claimant \_\_\_\_\_

#4850221

\*\*\*\*\*FINAL ADJUDICATION\*\*\*\*\*

DATE \_\_\_\_\_ INITIALS \_\_\_\_\_

AMC462234



**LOCATION NOTICE FOR PLACER MINING CLAIM**

NOTICE IS HEREBY GIVEN that the GWD-01 placer mining claim has been located by Night Hawk Mining, whose current mailing address is, 3939 Barbara Loop SE, Rio Rancho, NM 87124.

BLM  
DATE  
STAMP  
2020 DEC - 8 A 8:47  
PHOENIX, ARIZONA

RECEIVED  
BLM ARIZONA STATE OFFICE

The general course of this claim is North to South and is situated in Yavapai County, Arizona.

The claim is 1,320 feet in length and 660 feet in width. This claim runs from the location monument on which the location notice is posted (being the northeast corner of the said claim), approximately 1320 feet in a southerly direction to the south end line and 660 feet in a easterly direction to the west end line.

The claim is marked by four 2"x2"x4' monuments, one at each corner of the claim.

The location monument on which this notice is posted is situated within Section 15, Township 12 North, Range 3 West, Gila Salt River Base and Meridian, Arizona. This claim encompasses portions of the following quarter section (s), section (s), Township (s) and Range (s)

W 1/2 of the SE 1/4 of the SE 1/4 of the East 1/2 of Section 15 Township 12 North, Range 3 West, Gila Salt River Base and Meridian, Arizona.

The locality of this claim with reference to some natural object or permanent monument and additional information (if any) concerning its locality are as follows: none

DATED AND POSTED on the ground this 30th day of November , 2020.

LOCATOR (s) Owners

Night Hawk Mining

By 

Agent for Owners

AMC 462234

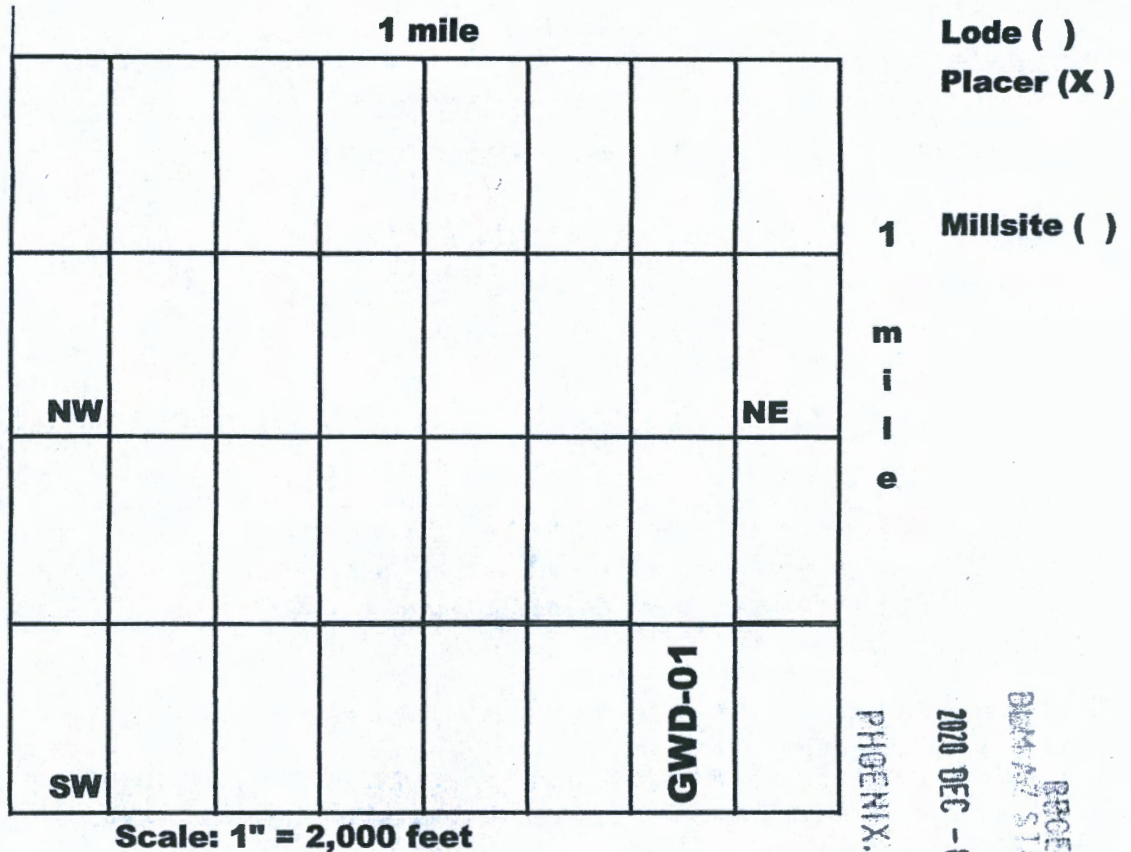

1. The above map depicts the GWD-01 mining claim which is located in Section 15, Township 12, Range 3, Gila and Salt river Base and Meridian. Yavapai County, Arizona. Total Claim acreage is 20 acres.
  2. The type of corner and location monuments used are as follows: 2"X2"X4' wooden post.
  3. The bearings and distances in degrees and feet between claim corners and to a public land survey monument are as depicted on the map.
  4. If the claim is a placer or millsite claim with exterior limits conforming to legal subdivision of the public survey, provide a legal description of the claim
- W 1/2, SE1/4 SE1/4 SE 1/4 EAST 1/2 SECTION 15 T12N R3W**

AN0462234



# LR2000 Internal

## CR Geographic Report with Land

**Download User Guide (pdf)**

**Purpose:** This report produces a geographic listing of case information based on retrieval by Meridian/Township/Range. This report format will display the case type, case disposition, meridian, township, range, section, survey type, survey number, surface management agency, pending actions, serial number, and total case acres.

To refresh the query, do a **Ctrl-R**. It resets the page and clears any criteria fields that may have entries.



### No Results

The specified criteria didn't result in any data. This is often caused by applying filters and/or selection steps that are too restrictive or that contain incorrect values. Please check your analysis filters and selection steps, and try again. The filters or selection steps currently being applied are shown below.

### Filters

Disposition is equal to **AUTHORIZED, CANCELLED, EXPIRED, PENDING, REJECTED, RELINQUISHED, WITHDRAWN**  
**and** Meridian Township Range Section is equal to **14 0120N 0030W 015**  
**and** Admin State is equal to **AZ**

Return - Refresh



U.S. POSTAGE PAID  
PM 2-Day  
RIO RANCHO, NM  
87124  
DEC 04, 20  
AMOUNT  
**\$7.75**  
R2307M152690-05

1006



85004



# PRIORITY<sup>®</sup> MAIL

- Date of delivery specified\*
- USPS TRACKING™ included to many main- international destinations.
- Limited international insuran
- Pick up available.\*
- Order supplies online.\*
- When used internationally, a cus- declaration label may be require
- \* Domestic only

EXPECTED DELIVERY DAY: 12/07/20  
USPS TRACKING® NUMBER



9505 5125 9534 0339 6277 88

Package Pickup,  
scan the QR code.



USPS.COM/PICKUP



PS00001000014

EP14F Oct 2018  
OD: 12 1/2 x 9 1/2

FROM:

**PRIORITY<sup>®</sup>  
★ MAIL ★**



VISIT US AT USPS.COM<sup>\*</sup>  
ORDER FREE SUPPLIES ONLINE

FROM:

NIGHT-HAWK

3939 BARBADA LOOP

RIO RANCHO

PHOENIX ARIZONA  
RECEIVED  
PHOENIX ARIZONA  
DEC 04 8 43 AM '18

TO: BEM

ARIZONA STATE OFFICE

1 N. CENTRAL AVE

# 800

PHOENIX AZ

85004

Label 228, March 2016

FOR DOMESTIC AND INTERNATIONAL USE



This envelope is made from post-consumer waste. Please recycle - again.

\* Domestic only. \* For Domestic shipments, the maximum weight is 70 lbs. For international shipments, the maximum weight is 4 lbs.

This packaging is the property of the U.S. Postal Service<sup>®</sup> and is provided solely for use in sending Priority Mail<sup>®</sup> shipments. Misuse may be a violation of federal law. This packaging is not for resale. EP14F © U.S. Postal Service; October 2018. All rights reserved.